

**MANHOLE COVER**

(2 COVERS REQUIRED PER FRAME)

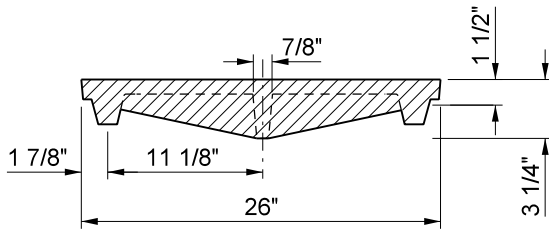

**SECTION "A-A"**

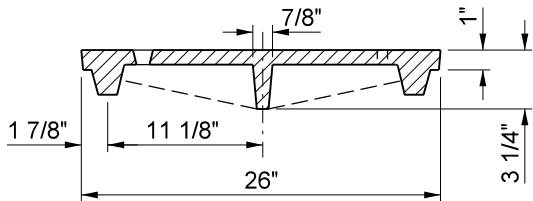

**SECTION "B-B"**

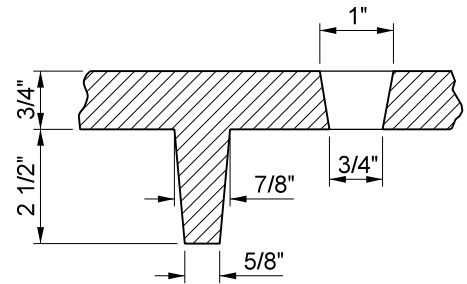

**SECTION "C-C"**

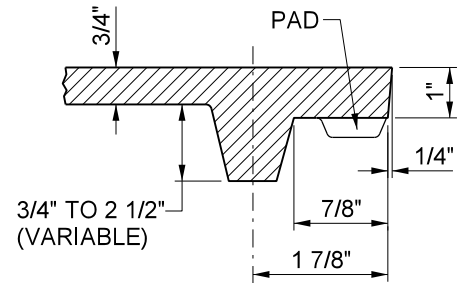

**SECTION "D-D"**

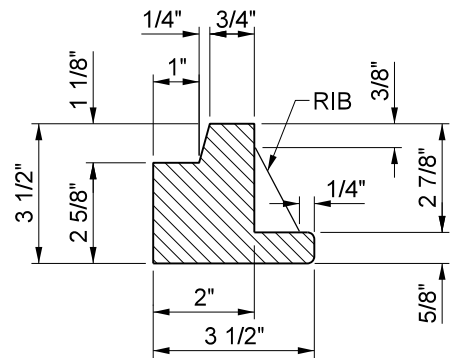

**SECTION "E-E"**

**NOTE:**

EXPOSED METAL & COVER TO BE OT-DIP GALVANIZED AFTER FABRICATION.

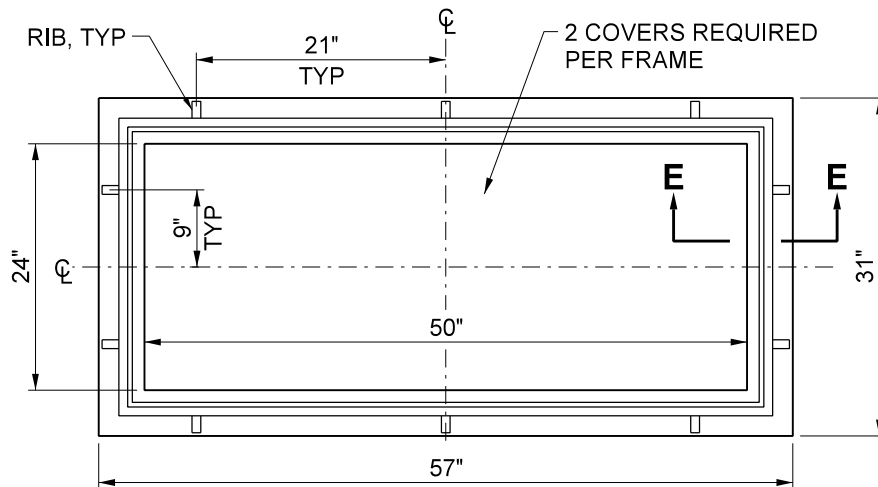

**MANHOLE FRAME**

NOT TO SCALE

PREPARED UNDER THE SUPERVISION OF:

*Mark Lancaster*

11/30/22

DIRECTOR OF TRANSPORTATION  
MARK LANCASTER, P.E.

DATE



COUNTY OF RIVERSIDE

**RECTANGULAR  
MANHOLE  
FRAME AND COVER**

STANDARD No. 611

REVISION	DESCRIPTION	MARK	DATE	APPROVED